

433MHZ OUTDOOR TEMPERATURE TRANSMITTER FOR USE WITH THE TEMPERATURE STATION

Congratulations on purchasing this optional 433 MHz Outdoor Temperature Transmitter for use with the Temperature Station. Please read the following information to ensure that this transmitter works correctly.

OUTDOOR TEMPERATURE TRANSMITTER

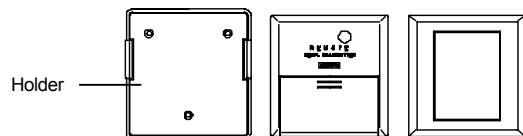

FEATURES OF THE OUTDOOR TEMPERATURE TRANSMITTER:

- Remote transmission of outdoor temperature via 433MHz to base Temperature Station.
- Wall mounting holder.

SETTING UP:

Before activating the Outdoor Temperature Transmitter for use with the base receiver Temperature Station, ensure all batteries are removed from each of the units for at least 30 seconds before proceeding with these steps:

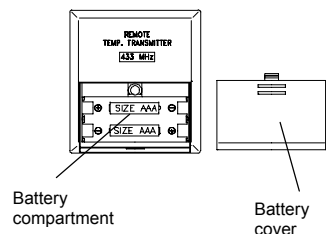

1. Insert 2 x AA, IEC LR6, 1.5V batteries, observing correct polarity, into the battery compartment of the Temperature Station.
2. Slide to open the temperature transmitter's battery cover, insert 2 x AAA, IEC LR3, 1.5V batteries into the battery compartment and replace cover.
3. If you have purchased additional outdoor transmitter(s), ensure that you leave 10 seconds for the signal reception of the first transmitter before setting up the following transmitter; i.e. the first transmitter will have the temperature displayed with the number 1 against it and so on.
4. Repeat step 2 - 3 for each additional Outdoor Temperature Transmitter.
5. Position the Outdoor Temperature Transmitter in the desired locations (see **Affixing the Outdoor Temperature Transmitter**).

Immediately after power-up, the LCD segments will light up briefly on the base receiver Temperature Station before displaying the current indoor temperature in °C. When the Outdoor Temperature Transmitter has transmitted data by 433MHz, it will register accordingly on the LCD of the base receiver. For full operating instructions, please refer to the main instruction manual for the Temperature Station.

Notes:

- Setting up should not take longer than three minutes to complete otherwise start up problems may occur.
- When installing the batteries always check the correct polarity before inserting and ensure the batteries do not spring free from the contacts otherwise start up problems may occur.
- If setting up has taken over three minutes, then reset the units (see "Resetting" below).

433MHZ SIGNAL RECEPTION

If the outdoor temperature is not received within three minutes after setting up, the display will show "-- °C" on the outdoor temperature section of the receiver, please check the following points:

1. Distance transmitters at least 2 meters away from any interfering sources such as computer monitors or TV sets.
2. Avoid placing the temperature transmitter onto or in the immediate proximity of metal window frames.
3. Using other electrical products such as headphones or speakers operating on the 433MHz frequency may prevent reception of the transmitted data. Interference can also be caused by neighbours using similar electrical devices.

AFFIXING THE OUTDOOR TEMPERATURE TRANSMITTER:

The Outdoor Temperature Transmitter has a holder and is supplied with screws and double-sided tape for affixing by either method preferred. Before securing the transmitter to the desired location, **check that the temperature can be received first**.

To affix by screw, follow these steps:

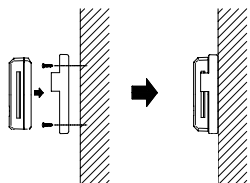

1. Using the holes in the holder as a guide, mark the holes on the drilling surface.
2. Drill the marked area to the required depth.
3. Screw the holder onto wall and click the transmitter into holder.

To affix using double-sided tape, follow these steps:

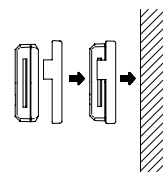

1. Clean both surfaces before affixing double-sided tape.
2. Peel one side of the tape and press it firmly against the back of the holder.
3. Now peel the other side of the tape and stick the holder firmly onto the surface. Do not stick onto bricks, enamel finished or greasy surfaces.

Note: Do not secure the transmitter on metal frames or doors because this may cause interference with 433MHz transmission.

RESETTING:

There are times when the receiver unit and the Outdoor Temperature Transmitter needs to be reset for example a changing of batteries

1. Remove the batteries from each unit and wait at least 30 seconds.
2. Proceed from step 1 in **Setting up**.

BATTERY CHANGE:

For best performance and running accuracy the batteries of all units should be replaced at least once a year.



Please help in the preservation of the environment and return used batteries to an authorized depot only.

MAINTENANCE:

- Avoid placing the units in locations prone to extreme temperatures, vibration and shock since these may cause damage and inaccurate readings.
- Do not submerge any of the units in water or use them in any way other than what they have been designed for.
- Remove all low powered batteries immediately to avoid leakage and damage. Replace only with new batteries of the recommended type.
- Do not make any repairs to the units. Return to the original point of purchase for repair by qualified personnel.

OUTDOOR TEMPERATURE TRANSMITTER SPECIFICATIONS:

• Temperature measuring range	: -30°C to +70°C with 0.1°C resolution
• Transmission interval	: every 1 minute
• Transmission frequency	: 433.92 MHz
• Transmission range	: 25m max
• Power Sources	: 2 x 1.5V-Battery AAA, IEC LR3
• Dimensions	: 59 x 22 x 65 mm

LIABILITY DISCLAIMER:

- The manufacturer and supplier cannot accept any responsibility for any incorrect readings and any consequences occurring should an inaccurate reading take place.
- This product is not to be used for medical purposes or for public information.
- The specifications of this product may change without prior notice.
- This product is not a toy. Keep out children's reach.
- No part of this manual may be reproduced without written consent of the manufacturer.

R&TTE Directive 1999/5/EC

Summary of the Declaration of Conformity : We hereby declare that this wireless transmission device does comply with the essential requirements of R&TTE Directive 1999/5/EC.